

三亚市防灾减灾实战实训基础设施建设项目及周边道路用地界址图

内部用图

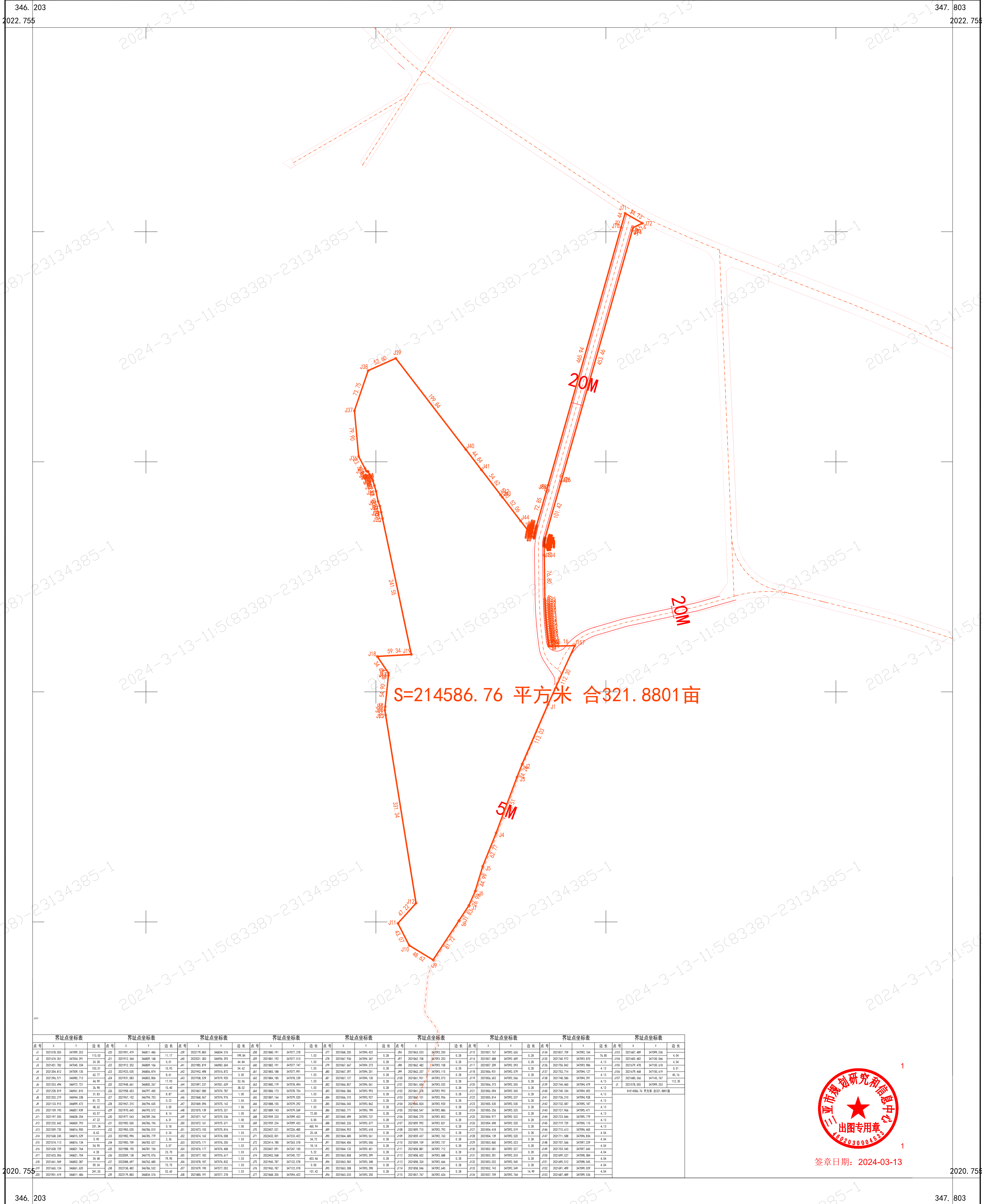

S=214586.76 平方米 合321.8801亩

界址点坐标表			界址点坐标表			界址点坐标表			界址点坐标表			界址点坐标表			界址点坐标表			界址点坐标表			界址点坐标表														
点号	X	Y	边长	点号	X	Y	边长	点号	X	Y	边长	点号	X	Y	边长	点号	X	Y	边长	点号	X	Y	边长	点号	X	Y	边长	点号	X	Y	边长	点号	X	Y	边长
J1	202193.05	34709.253	115.03	J20	202191.419	34681.480	11.17	J29	202178.883	34684.576	199.84	J38	202188.191	34717.278	1.03	J47	202168.205	34704.422	0.28	J56	202168.033	34709.520	0.28	J65	202165.767	34709.626	0.28	J74	202163.759	34709.764	76.80	J83	202167.489	34709.526	4.04
J2	202194.281	34704.297	24.28	J21	202193.344	34689.168	6.91	J30	202170.301	34695.293	44.84	J39	202181.192	34717.210	1.03	J48	202167.786	34703.203	0.28	J57	202165.408	34709.809	0.28	J66	202163.112	34709.818	4.13	J75	202161.487	34709.581	4.04				
J3	202195.782	34704.324	103.51	J22	202192.352	34695.166	16.93	J31	202189.819	34703.024	54.62	J40	202182.191	34717.747	1.03	J49	202162.482	34703.913	0.28	J58	202160.209	34709.919	0.28	J67	202158.842	34709.186	4.13	J76	202157.478	34709.418	0.01				
J4	202194.812	34709.135	62.77	J23	202193.033	34683.874	6.67	J32	202192.498	34704.872	5.00	J41	202187.397	34704.281	0.28	J50	202162.207	34703.115	0.28	J59	202160.911	34709.579	0.28	J68	202159.374	34704.127	4.13	J77	202157.468	34708.419	45.16				
J5	202194.511	34685.713	44.99	J24	202193.083	34683.806	17.93	J33	202192.529	34705.920	32.56	J42	202184.185	34707.239	1.03	J51	202161.921	34703.073	0.28	J60	202160.623	34709.566	0.28	J69	202159.086	34704.291	4.13	J78	202157.266	34704.767	45.16				
J6	202193.494	34697.721	16.99	J25	202194.661	34680.267	12.40	J34	202191.237	34705.629	38.02	J43	202186.179	34707.484	1.03	J52	202161.657	34703.022	0.28	J61	202160.373	34709.545	0.28	J70	202158.746	34704.479	4.13	J79	202156.855	34709.253	112.39				
J7	202193.819	34691.810	31.83	J26	202195.653	34677.400	8.87	J35	202187.080	34704.787	1.00	J44	202181.173	34707.754	1.03	J53	202161.066	34709.919	0.28	J62	202159.784	34709.545	0.28	J81	202158.134	34704.492	4.13	J80	202156.266	34709.253	112.39				
J8	202192.219	34694.338	81.72	J27	202197.102	34674.703	8.87	J36	202186.567	34704.976	1.04	J45	202181.164	34707.020	1.03	J54	202160.915	34709.927	0.28	J63	202159.624	34709.537	0.28	J82	202157.918	34704.928	4.13	J81	202156.046	34709.526	4.04				
J9	202193.915	34689.472	48.62	J28	202197.315	34674.635	3.50	J37	202189.096	34705.142	1.06	J46	202184.063	34707.912	1.03	J55	202160.593	34709.832	0.28	J64	202159.304	34709.520	0.28	J83	202157.607	34705.187	4.13	J82	202155.729	34709.584	4.04				
J10	202191.163	34683.797	43.07	J29	202199.645	34670.572	6.91	J38	202181.139	34705.211	1.06	J47	202184.143	34707.648	72.85	J56	202160.711	34709.749	0.28	J65	202159.421	34709.886	0.28	J84	202157.741	34705.187	4.13	J83	202155.855	34709.671	4.13				
J11	202197.625	34688.254	47.22	J30	202197.543	34679.246	6.31	J39	202187.167	34705.524	1.05	J48	202181.133	34709.433	72.85	J57	202160.499	34709.727	0.28	J66	202159.210	34709.823	0.28	J85	202157.566	34705.187	4.13	J84	202155.969	34709.579	4.13				
J12	202192.442	34689.793	47.22	J31	202198.065	34676.196	6.31	J40	202187.161	34705.671	1.00	J49	202181.124	34709.433	5.00	J58	202160.226	34709.877	0.28	J67	202159.042	34709.821	0.28	J86	202157.429	34705.110	4.13	J85	202155.969	34709.579	4.13				
J13	202199.735	34684.900	33.34	J32	202198.035	34676.196	6.31	J41	202187.155	34705.816	1.00	J50	202184.056	34709.433	48.94	J59	202160.143	34709.818	0.28	J68	202159.715	34709.821	0.28	J87	202157.311	34705.110	4.13	J86	202155.969	34709.579	4.13				
J14	202198.245	34681.529	6.02	J33	202198.996	34676.779	2.38	J42	202187.163	34705.008	1.03	J51	202184.040	34709.561	25.44	J60	202160.140	34709.818	0.28	J69	202159.437	34709.763	0.28	J88	202157.158	34705.110	4.13	J87	202155.969	34709.579	4.13				
J15	202194.113	34681.134	5.00	J34	202198.709	34673.527	5.07	J43	202187.171	34705.205	1.03	J52	202184.001	34713.422	24.72	J61	202160.140	34709.818	0.28	J70	202159.715	34709.821	0.28	J89	202157.049	34705.110	4.13	J88	202155.969	34709.579	4.13				
J16	202193.729	34682.794	4.28	J35	202198.192	34671.156	23.70	J44	202187.177	34705.408	1.03	J53	202184.011	34713.422	13.14	J62	202160.140	34709.818	0.28	J71	202159.715	34709.821	0.28	J90	202156.781	34705.110	4.13	J89	202155.969	34709.579	4.13				
J17	202193.026	34682.794	34.48	J36	202199.139	34670.076	79.90	J45	202187.183	34705.617	1.03	J54	202184.008	34713.422	43.44	J63	202160.140	34709.818	0.28	J72	202159.715	34709.821	0.28	J91	202156.513	34705.110	4.13	J90	202155.969	34709.579	4.13				
J18	202191.689	34682.397	99.34	J37	202199.497	34670.480	6.6	J46	202187.187	34705.822	0.28	J55	202184.011	34713.422	0.00	J64	202160.140	34709.818	0.28	J73	202159.715	34709.821	0.28	J92	202156.245	34705.110	4.13	J91	202155.969	34709.579	4.13				
J19	202195.124	34681.620	241.55	J38	202198.482	34676.522	52.90	J47	202187.193	34707.022	1.03	J56	202184.008	34713.422	101.42	J65	202160.140	34709.818	0.28	J74	202159.715	34709.821	0.28	J93	202155.969	34709.579	4.13	J92	202155.969	34709.579	4.13				
J20	202191.419	34681.480		J39	202199.883	34684.576		J48	202188.191	34707.278		J57	202184.022	34713.422		J66	202160.140	34709.818		J75	202159.715	34709.821		J94	202155.969	34709.579		J93	202155.969	34709.579					



签章日期: 2024-03-13

2016年4月数字化制图
国家2000坐标系
国家85高程基准, 等高距为0.5米
2007年图式

1:4000

存档数据: 2024. 3. 13