

三亚市迎宾路中段学校配套市政工程用地界址图

内部用图

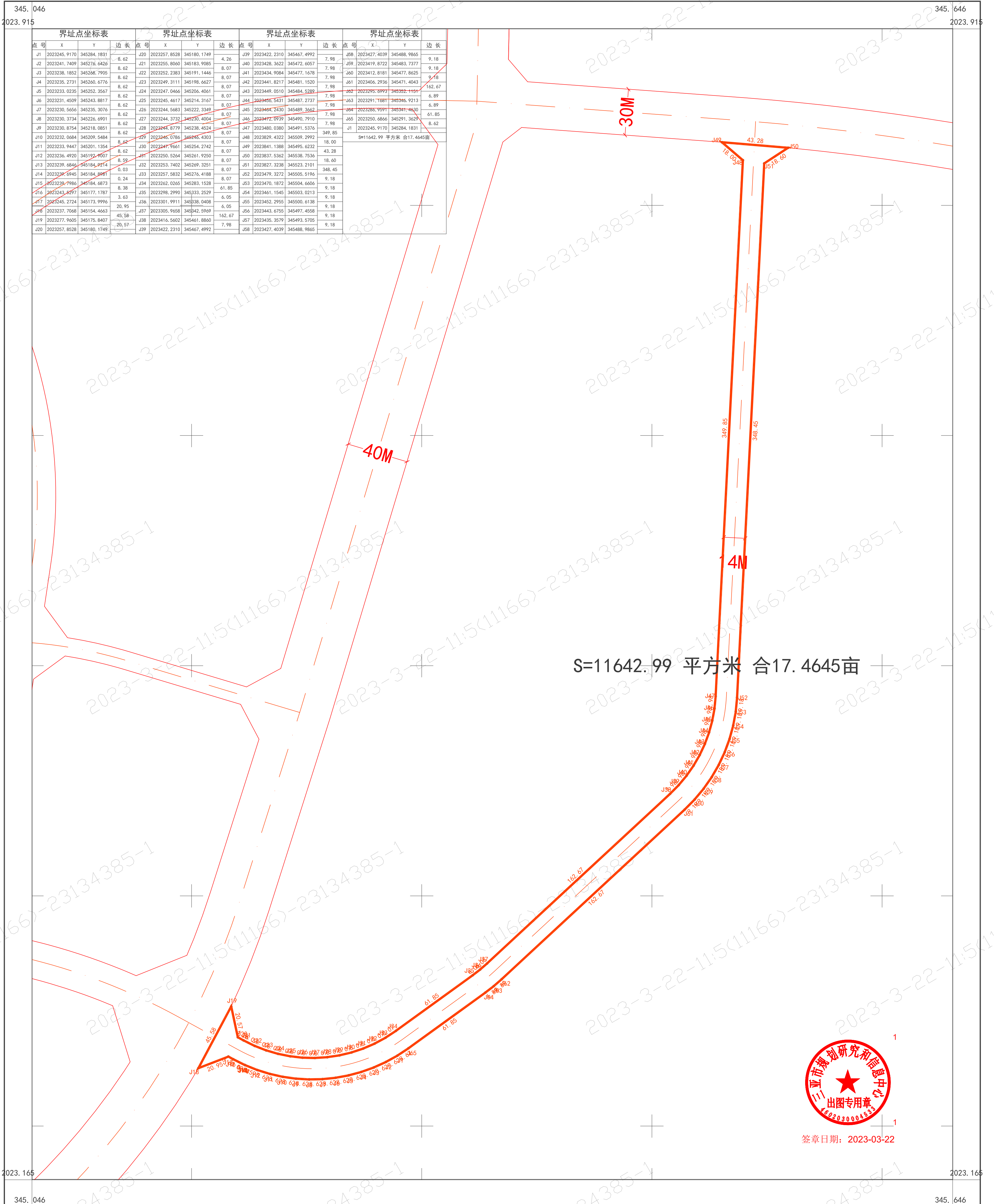

界址点坐标表				界址点坐标表				界址点坐标表				界址点坐标表			
点号	X	Y	边长	点号	X	Y	边长	点号	X	Y	边长	点号	X	Y	边长
J1	2023245.9170	345284.1831	8.62	J20	2023257.8528	345180.1749	4.26	J39	2023422.2310	345467.4992	7.98	J58	2023427.4039	345488.9865	9.18
J2	2023241.7409	345276.6426	8.62	J21	2023255.8060	345183.9085	8.07	J40	2023428.3622	345472.6057	7.98	J59	2023419.8722	345483.7377	9.18
J3	2023238.1852	345268.7905	8.62	J22	2023252.2383	345191.1446	8.07	J41	2023434.9084	345477.1678	7.98	J60	2023412.8181	345477.8625	9.18
J4	2023235.2731	345260.6776	8.62	J23	2023249.3111	345198.6627	8.07	J42	2023441.8217	345481.1520	7.98	J61	2023406.2936	345471.4043	9.18
J5	2023233.0235	345252.3567	8.62	J24	2023247.0466	345206.4061	8.07	J43	2023449.0510	345484.5289	7.98	J62	2023295.6993	345392.1194	162.67
J6	2023231.4509	345243.8817	8.62	J25	2023245.4617	345214.3167	8.07	J44	2023455.5431	345487.2737	7.98	J63	2023291.7081	345346.9213	6.89
J7	2023230.5656	345235.3076	8.62	J26	2023244.5683	345222.3349	8.07	J45	2023464.2430	345489.3662	7.98	J64	2023286.9591	345341.4630	6.89
J8	2023230.3734	345226.6901	8.62	J27	2023244.3732	345230.4004	8.07	J46	2023472.0939	345490.7910	7.98	J65	2023250.6866	345291.3629	61.85
J9	2023230.8754	345218.0851	8.62	J28	2023244.8779	345238.4524	8.07	J47	2023480.0380	345491.5376	7.98	J1	2023245.9170	345284.1831	8.62
J10	2023232.0684	345209.5484	8.62	J29	2023245.0786	344926.4303	8.07	J48	2023489.4322	345509.2992	349.85	S=11642.99 平方米 合17.4645亩			
J11	2023233.9447	345201.1354	8.62	J30	2023247.9661	345254.2742	8.07	J49	2023841.1388	345495.6232	18.00				
J12	2023236.4920	345192.9007	8.59	J31	2023250.5264	345261.9250	8.07	J50	2023837.5362	345538.7536	43.28				
J13	2023239.6846	345184.9214	0.03	J32	2023253.7402	345269.3251	8.07	J51	2023827.3238	345523.2101	348.45				
J14	2023239.6945	345184.8981	0.24	J33	2023257.5832	345276.4188	8.07	J52	2023479.3272	345505.5196	9.18				
J15	2023239.9986	345184.6873	8.38	J34	2023262.0265	345283.1528	61.85	J53	2023470.1872	345504.6606	9.18				
J16	2023243.8297	345177.1787	3.63	J35	2023298.2990	345333.2529	6.05	J54	2023461.1545	345503.0213	9.18				
J17	2023245.2724	345173.9996	20.95	J36	2023301.9911	345338.0408	6.05	J55	2023452.2955	345500.6138	9.18				
J18	2023237.7068	345154.4663	45.58	J37	2023305.9658	345342.5969	162.67	J56	2023443.6755	345497.4558	9.18				
J19	2023277.9605	345175.8407	20.57	J38	2023416.5602	345461.8860	7.98	J57	2023435.3579	345493.5705	9.18				
J20	2023257.8528	345180.1749		J39	2023422.2310	345467.4992		J58	2023427.4039	345488.9865					

S=11642.99 平方米 合17.4645亩



签章日期: 2023-03-22