

海棠湾A8片区A8-01-09 (1)、A8-01-09 (2) 地块及A8-01-19地块征地（申请征地文部分）土地调查红线图

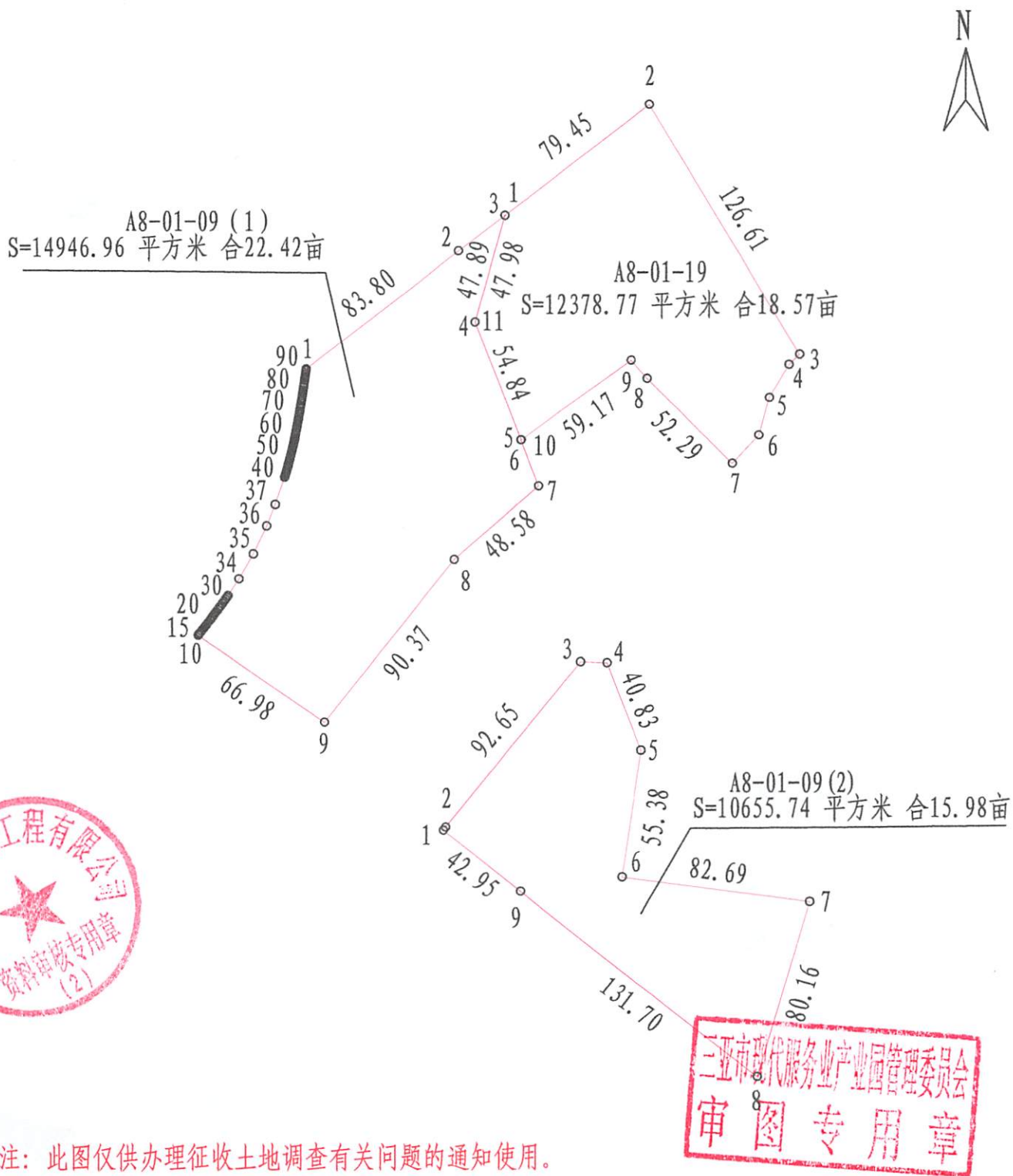

海南测达测绘工程有限公司



注：此图仅供办理征收土地调查有关问题的通知使用。

绘图员：王海铨

1: 2500

单位：平方米、米

检核员：王 兴

2020年08月21日

A8-01-19界址点坐标表

点号	X	Y	边长
1	34274.313	133354.067	
			79.45
2	34322.423	133417.296	
			126.61
3	34214.118	133482.866	
			6.41
4	34209.666	133478.254	
			16.84
5	34195.168	133469.689	
			16.77
6	34179.026	133465.131	
			16.96
7	34166.768	133453.417	
			52.29
8	34203.602	133416.305	
			10.68
9	34211.564	133409.190	
			59.17
10	34177.072	133361.108	
			54.84
11	34228.124	133341.088	
			47.98
1	34274.313	133354.067	
S=12378.77 平方米 合18.57亩			

A8-01-09 (1) 界址点坐标表

点号	X	Y	边长	点号	X	Y	边长	点号	X	Y	边长
1	34208.094	133267.121		20	34099.124	133225.192		39	34161.614	133257.926	
2	34258.835	133333.808	83.80	21	34099.886	133225.792	0.97	40	34162.257	133258.119	0.67
3	34274.232	133354.044	25.43	22	34100.688	133226.413	1.01	41	34162.915	133258.312	0.69
4	34228.124	133341.088	47.89	23	34101.512	133227.049	1.04	42	34163.571	133258.504	0.68
5	34177.072	133361.108	54.84	24	34102.274	133227.628	0.96	43	34164.555	133258.787	1.02
6	34176.972	133360.969	0.17	25	34102.807	133228.032	0.67	44	34165.536	133259.060	1.02
7	34156.956	133368.790	21.49	26	34103.599	133228.627	0.99	45	34166.189	133259.242	0.68
8	34125.300	133331.938	48.58	27	34104.423	133229.237	1.03	46	34166.842	133259.418	0.68
9	34054.876	133275.300	90.37	28	34105.175	133229.791	0.93	47	34167.493	133259.594	0.67
10	34092.559	133219.924	66.98	29	34106.370	133230.659	1.48	48	34168.144	133259.766	0.67
11	34093.073	133220.266	0.62	30	34107.441	133231.426	1.32	49	34169.047	133260.003	0.93
12	34093.564	133220.678	0.64	31	34108.281	133232.017	1.03	50	34170.092	133260.269	1.08
13	34094.374	133221.353	1.05	32	34109.083	133232.579	0.98	51	34170.739	133260.432	0.67
14	34095.303	133222.120	1.20	33	34109.831	133233.093	0.91	52	34171.385	133260.594	0.67
15	34096.057	133222.737	0.97	34	34117.094	133237.847	8.68	53	34172.030	133260.751	0.66
16	34096.563	133223.146	0.65	35	34127.930	133244.082	12.50	54	34172.675	133260.908	0.66
17	34097.070	133223.558	0.65	36	34140.076	133249.976	13.50	55	34173.724	133261.158	1.08
18	34097.580	133223.966	0.65	37	34149.010	133253.645	9.66	56	34174.602	133261.361	0.90
19	34098.331	133224.567	0.96	38	34161.024	133257.748	12.70	57	34175.242	133261.509	0.66
20	34099.124	133225.192	1.01	39	34161.614	133257.926	0.62	58	34175.881	133261.654	0.66

A8-01-09 (1) 界址点坐标表

点号	X	Y	边长	点号	X	Y	边长
58	34175.881	133261.654		77	34190.614	133264.537	
			0.65				0.89
59	34176.520	133261.796		78	34191.495	133264.684	
			0.65				0.62
60	34177.157	133261.937		79	34192.104	133264.786	
			0.65				0.86
61	34177.793	133262.076		80	34192.952	133264.925	
			0.65				0.98
62	34178.428	133262.214		81	34193.922	133265.082	
			0.97				0.61
63	34179.379	133262.416		82	34194.526	133265.178	
			0.94				0.82
64	34180.299	133262.606		83	34195.332	133265.306	
			0.67				1.01
65	34180.957	133262.741		84	34196.328	133265.460	
			0.64				0.93
66	34181.587	133262.869		85	34197.251	133265.603	
			0.98				0.88
67	34182.545	133263.060		86	34198.120	133265.732	
			0.94				0.81
68	34183.468	133263.240		87	34198.920	133265.853	
			0.64				1.23
69	34184.093	133263.361		88	34200.139	133266.031	
			0.63				0.95
70	34184.716	133263.479		89	34201.076	133266.167	
			0.63				0.83
71	34185.339	133263.596		90	34201.897	133266.285	
			0.89				1.27
72	34186.218	133263.761		91	34203.159	133266.465	
			1.00				0.83
73	34187.199	133263.938		92	34203.983	133266.579	
			0.99				0.83
74	34188.176	133264.115		93	34204.805	133266.693	
			0.88				0.93
75	34189.048	133264.266		94	34205.722	133266.819	
			0.62				0.85
76	34189.661	133264.373		95	34206.561	133266.934	
			0.97				0.89
77	34190.614	133264.537		96	34207.448	133267.053	
							0.65
				1	34208.094	133267.121	
S=14946.96 平方米 合22.42亩							

A8-01-09(2)界址点坐标表

点号	X	Y	边长
1	34008.020	133327.202	
			1.65
2	34009.353	133328.181	
			92.65
3	34080.830	133387.126	
			11.59
4	34080.378	133398.712	
			40.83
5	34042.350	133413.570	
			55.38
6	33987.593	133405.298	
			82.69
7	33976.811	133487.286	
			80.16
8	33899.980	133464.429	
			131.70
9	33981.393	133360.907	
			42.95
1	34008.020	133327.202	
S=10655.74 平方米 合15.98亩			